



MEDER BasicGuide & BasicGuide mini

OPERATING INSTRUCTIONS

1. Table of contents

1. Table of contents.....	2	6.3 BasicGuide Transmitter.....	19
2. Safety instructions.....	4	Switching on the device/connecting the microphone.....	19
3. Introduction.....	5	Connecting an external sound source to the transmitter....	19
4. Part designations and operating elements	6	Set channel.....	19
Transmitter	6	Remote channel setting.....	20
Receiver.....	7	The programming menu.....	21
Charging technology.....	8	Setting the sensitivity (microphone sensitivity)	22
5. Storage, commissioning of the system	9	Noise Gate einstellen.....	23
5.1 Storage of the components.....	9	7. Troubleshooting.....	24
5.2 Commissioning charging system	9	8. Manufacturer's declarations	26
Structure and connection, charging system	9	Guarantee.....	26
5.3 Commissioning/maintenance of transmitter and receiver	12	Rechargeable batteries and batteries.....	26
Initial commissioning.....	12	WEEE-Declaration	27
Inserting/replacing batteries or rechargeable batteries	12	Declaration of conformity.....	27
Attaching the windbreak	14	9. Technical data	28
Attaching devices to clothing	14	10. Accessories.....	31
Cleaning and care.....	14	11. Imprint.....	32
6. Operation.....	15		
6.1 BasicGuide Charging system.....	15		
Check charging status, charge devices.....	15		
6.2 BasicGuide Receiver.....	18		
Switch on device/connect headphones.....	18		
Adjust the volume and put on the earphones.....	18		
Set channel	18		

2. Safety instructions

Read the operating instructions and keep them. Always pass the devices on to other users together with the operating instructions.

Have all maintenance work carried out by qualified maintenance personnel. Maintenance work must be carried out if the appliances have been damaged in any way.



WARNING! Hitze- und Feuerentwicklung, Rauch- und Gasentwicklung, Explosionsgefahr, Umweltschäden

If used improperly, Ni-MH rechargeable batteries and batteries can leak and, in extreme cases, cause serious damage. MEDER accepts no liability for improper use.

- Keep out of reach of children.
- Pay attention to polarity.
- Do not heat above 70°C/158°F. Don't throw it into the fire.
- Do not expose to moisture.
- Do not short-circuit, dismantle or deform.
- Switch off devices after use.
Only charge batteries at an ambient temperature of 10 °C/50 °F to 40 °C/104 °F.
- Do not mix charged rechargeable batteries and batteries without packaging.
- In the case of obviously defective devices, stop the charging process immediately.
- The rechargeable batteries and batteries supplied are recyclable. Please dispose of the rechargeable batteries via the battery container or specialist retailers.



CAUTION! Danger from leaking batteries

Batteries that are charged in a charging cabinet/charging station/charging case can leak. Batteries can also leak due to prolonged inactivity. The leaking electrolytes can cause damage to the devices.

- Never place devices that are equipped with batteries in the charging station, charging cabinet, or charging case.
- Remove the batteries from the devices if they are not to be devices. Do not mix full batteries without packaging.
- If a battery has leaked, avoid contact with the skin, eyes or mucous membranes at all costs. Affected areas should be rinsed immediately with plenty of clean water. Seek a doctor immediately afterwards.

3. Introduction

Thank you for the trust you have placed in our products. These products will impress you for many years to come with their reliability, economy and ease of use. The **MEDER BasicGuide**-system enables wireless sound transmission for conferences and group tours, e.g. in companies or museums. Transmission by radio signal allows all members of the group to move freely.

The following main features characterize this system:

- up to 30 channels
- High ease of use thanks to display
- Good voice quality
- Remote channel setting via infrared for quick setting of any number of receivers.
- Long operating time due to the low power consumption of the devices.
- State-of-the-art energy-saving charging technology with ΔU process. Trickle charging keeps all batteries ready for use at all times. The battery service life is increased, making this system very environmentally friendly.
- Standard battery size (Mignon, AA) for **BasicGuide** facilitates replacement and rechargeable battery (LiPo) in **BasicGuide mini** can be used continuously.
- Transmitter switches off when not in use.
- Made in Germany

4. Part designations and operating elements

Transmitter

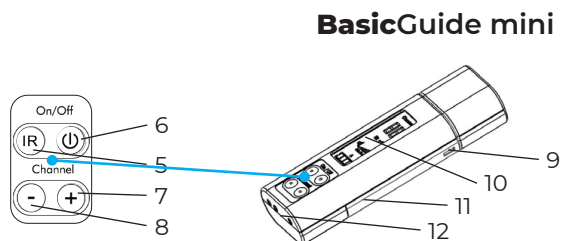
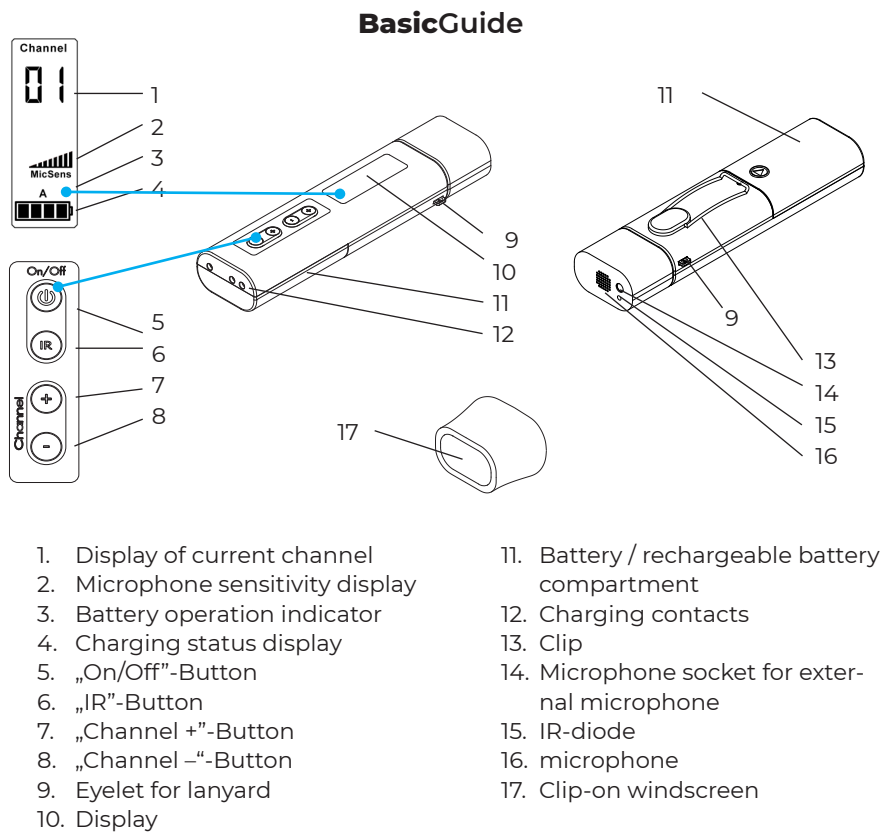

Receiver

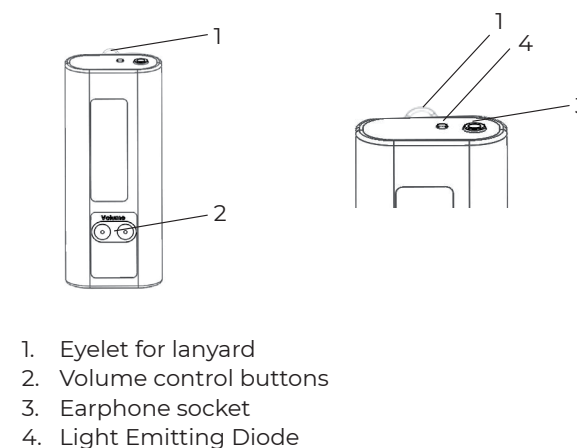
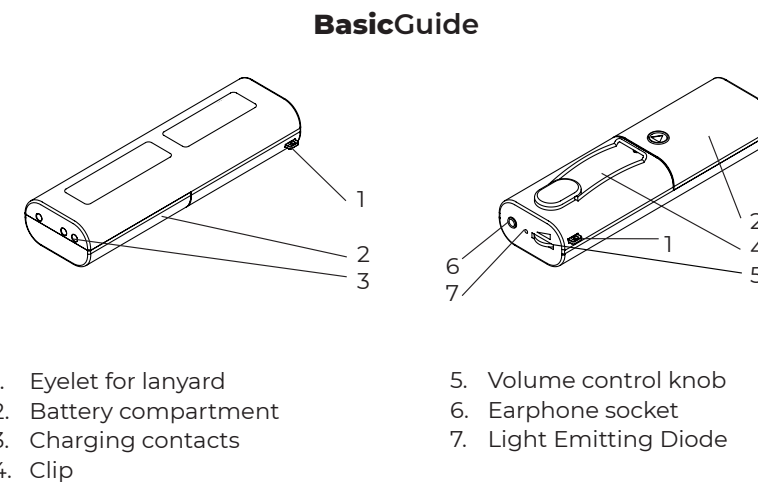

Charging systems

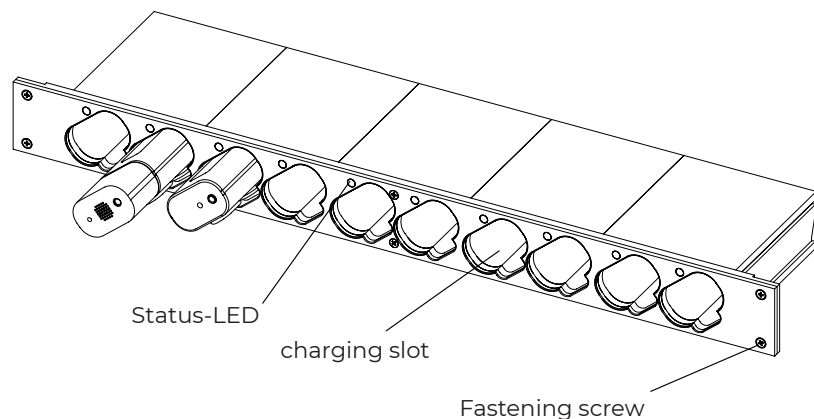

With **MEDER** charging technology, a battery is charged with a constant current. charged. The voltage curve is monitored and shows the following pattern:

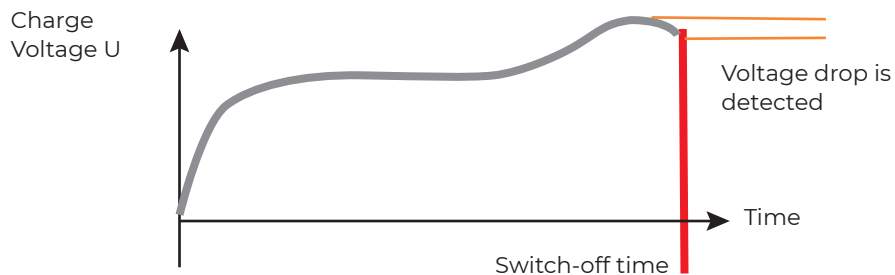

During the charging process, the battery voltage continues to rise. When the battery is full, however, its charging voltage reaches a maximum and drops again slightly as the current continues to flow. This slight voltage drop (hence: $-\Delta U$) is recognized by the charging electronics and the charge controller switches from fast charging to trickle charging. In addition, the temperature range is constantly monitored during charging.

5. Storage, commissioning of the system

5.1 Storage of the components

Store the devices in a cool, dry place when not in use. The optimum temperature range is $-10^{\circ}\text{C}/14^{\circ}\text{F}$ to $60^{\circ}\text{C}/140^{\circ}\text{F}$. Improper storage can reduce the service life of the appliance.

Proceed as follows when storing:

1. Remove earphones or external microphones from the devices.
2. Charge the batteries. If batteries are used, remove them, as the batteries the batteries may leak. Rechargeable batteries can remain in the transmitters and receivers. Observe the safety instructions on p. 4.
3. Disconnect the mains cable.
4. Store devices separately (e.g. in a case), as the devices discharge themselves in the charging slot when the mains voltage is switched off. Only the charging case is equipped with a special control system that prevents this effect.
5. Devices are ready for storage.

5.2 Charging system

Structure and connection

All charging systems are supplied pre-configured by **MEDER** and connected using an IEC cable, which is included in the delivery. Operation is identical for all variants (see point 6.0). The MEDER ($-\Delta U$) charging technology is available in all charging variants. The charging cabinet, the desktop charging station and the charging rack are equipped with 19" panels, each containing 10 charging slots per panel. Depending on the model and variant, these can be individually configured or extended.

When commissioning the desktop charging station or the charging rack, a minimum distance of 15 cm from the wall must be maintained.

Please observe the following instructions for good air circulation when charging the devices (battery operation) in the corresponding variants:

- Charging in the **charging case** is only permitted when it is open. The case lid must be open when charging.
- The front and rear of the **rack** must be open. A minimum distance of 15 cm from the wall must be maintained.
- A minimum distance of 15 cm from the wall must be maintained for the **desktop charging station**.
- The front and rear of the rack must be open on the **charging trolley**. The trolley must not be placed directly against the wall during the loading process.
- The charging process for the **charging cabinet** can also be carried out with the door closed.

Temperature-dependent fans are installed for air circulation. The operating noise can therefore vary.



ATTENTION! *Fire hazard*

The charging system and the transmitter and receiver batteries heat up during charging. The charging cabinet/charging station and the charging case have been developed for ambient temperatures from 10 °C/50 °F to 40 °C/104 °F.

- Ensure good air circulation.
- Do not block the ventilation openings.
- Do not expose the charging systems to heat sources or direct sunlight.
- Make sure that the case lid is always open when charging the devices in the charging case.



WARNING! *Fire hazard, electric shock*

Due to the high power consumption of the charging cabinet, cables or fuses can be overloaded. The power consumption is approx. 36 W per 10 charging bays.

- Check whether the socket outlet is suitable for this load. In particular, if many other power-intensive devices are connected in the room, the total load on the associated fuse must be checked.
- If you use an extension cable, it must be designed for the required load.

If you want to set up the charging system at a different location, proceed as follows:

1. Remove the transmitter and receiver from the charging system during transportation, as the devices could fall out. Only in the charging case the devices can be transported in the charging slot.
2. Set up the charging system on a level surface. Ensure adequate ventilation.
3. Connect the device to the power supply.
4. Only operate the charging case open.
5. Maintain a minimum distance of 15 cm from the wall at the rear of the desktop charging station, charging rack or charging trolley.
6. Charging cabinet can also be operated when closed.

5.3 Commissioning/maintenance of transmitter and receiver

Initial commissioning

The devices are supplied fully equipped.

For battery operation, the devices must be charged before first use, as indicated by an A above the battery indicator on the transmitter. The cover on the back of the receiver device is screwed on with a small screw.

With battery operation, you can start the first run immediately.

Changing batteries or rechargeable batteries

When the batteries/rechargeable batteries have reached the end of their service life, they must be replaced.

Use two 1.5 V Mignon batteries (AA, LR6 or suitable rechargeable batteries) for this purpose. Suitable replacement rechargeable batteries and batteries can be obtained from our Service Center. If you wish to convert from battery to rechargeable battery operation or from rechargeable battery to battery operation, please call the Service Center (this option is only available for the **BasicGuide**, the **BasicGuide mini** is equipped with a LiPo rechargeable battery which may only be replaced by the manufacturer). Standard batteries (Mignon, AA) can be changed at any time. However, this can lead to inaccuracies in the battery status display.

The battery compartment cover is secured with a screw for battery operation. The cover is not screwed on for battery operation.

Replacing the batteries or rechargeable batteries:

1. Loosen screw (if present).
2. Slide off the battery compartment cover.
3. Remove old/empty rechargeable batteries/batteries (if present).
4. Insert new rechargeable batteries/batteries. Pay attention to the polarity. The correct orientation is marked on the bottom of the battery compartment of the battery compartment. Incorrect insertion will damage the device.
5. Slide the battery compartment cover closed and, if necessary, screw attach.
6. The device is now ready for use.

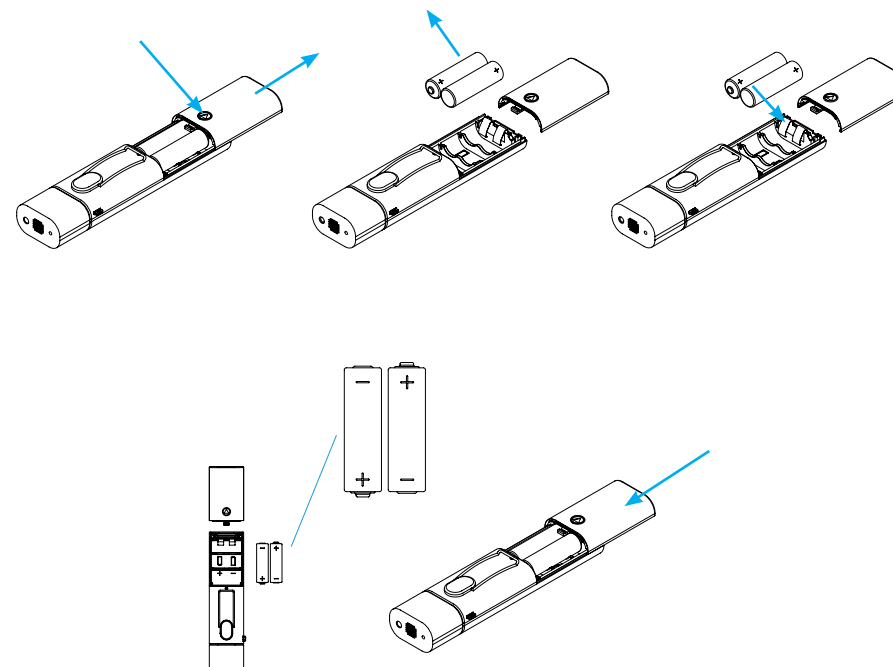

Attaching the windbreak

A windscreen can be attached to the transmitter microphone. This is made of foam rubber and prevents wind noise or breathing from negatively affecting the quality of the transmission. You can find a suitable windscreen in our accessories catalog.

The windscreen should be replaced regularly for hygienic reasons.

1. Remove old draft shield (if available).
2. Slide the new windscreen onto the microphone housing.

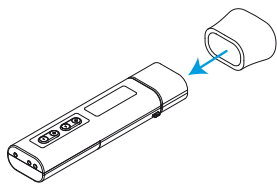

Attaching devices to clothing

The slim shape of the **BasicGuides** / **BasicGuides** mini makes it easy to carry in trouser or jacket pockets. Both the transmitter and receiver can be attached to clothing using the belt clip. There is also an eyelet for the lanyard at the top of the devices.

The lanyard can also be used to hang the devices around your neck. The eyelet can be folded out by moving the device. Then hook the carabiner hook of the lanyard into the eyelet. The use of the lanyard is recommended, as experience has shown that attaching the device to clothing without practice increases the risk of it falling off.

Cleaning and care

The transmitter, receiver and earphones can be cleaned with a damp cloth. Do not use aggressive solvents, as the plastic could be attacked.

For reliable cleaning of the earphones, **MEDER** recommends using a hygiene spray. This spray can be ordered from our Service Center.

6. Operation

6.1 BasicGuide Charging system

Check charging status, charge devices

The charging status of each appliance can be checked on the display at any time. In rechargeable battery mode, an **"A"** appears above the charging indicator in the display. If you wish to change from battery to rechargeable battery mode or from rechargeable battery to battery mode, please call the Service Center. In an emergency, however, standard batteries (Mignon, AA) can be changed at any time. However, this may result in inaccuracies in the battery status display.

The charge status is displayed visually as a bar graph. If there is a bar, there is still a remaining runtime of approx. 1 h. If no bar is displayed, the rechargeable battery or the battery is exhausted. The remaining running time is then approx. 10 min. A warning signal also sounds.

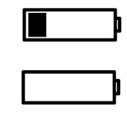

Recharge your devices regularly. The intelligent charging technology takes optimum care of the device batteries and guarantees a long battery life. After the charging process, trickle charging kicks in and keeps your devices ready for use at all times.



ATTENTION! Danger due to leaking batteries

Batteries that are charged in the charging cabinet/charging rack/tabletop charging station/charging case/charging trolley may leak. The leaking electrolytes can cause damage to the devices.

- Never place devices fitted with batteries in the charging system.
- A supplementary sheet is enclosed in the case for battery-powered devices. CAUTION Do not charge the BATTERY!

Proceed as follows to charge the devices:

1. Remove earphones or external microphones from the devices (if available).
2. Insert the devices into the charging slots with the base first. Look out for dirt on the device. In addition, small iron parts can stick to the built-in magnet at the bottom of the device. Please remove any dirt or iron parts before charging.
3. A status LED is located next to each charging slot to monitor charging. When a device is inserted, it lights up and indicates the status of the device.

BASIC GUIDE - NIMH RECHARGEABLE BATTERY

Status LED indicator	Meaning
RED	Device is charging
RED Flashing	Error: Defective battery
YELLOW	Error: temperature too low
GREEN	Fully charged, trickle charging is carried out

BASIC GUIDE MINI - LIPO RECHARGEABLE BATTERY

Status LED indicator	Meaning
GREEN Flashing	Device is charging
GREEN	Fully charged, trickle charging is carried out

4. The charging process begins when there are no faults. A discharged device needs about 2-3 hours to be fully charged again.
5. Partially charged devices can be removed from the charging slot if required. The removal is detected and the charging slot is automatically switched off. **MEDER** recommends that the devices are always fully charged.
6. Leaving charged devices in the charging slot is not harmful, as the intelligent charging technology switches to trickle charging after fast charging.

The batteries age through use and lose some of their charging capacity over time. part of their charging capacity. As a rule, batteries must be replaced after around 1.5 years. be replaced.

Indications that may point to old or defective batteries:

- Short charging time, even though the device was empty before charging.
- Short battery life during operation

If an empty device changes to fully charged after just a few minutes, the battery may have been deeply discharged. Briefly remove the device from the charging slot and start a new charging process. If this does not help even after several repetitions, the battery is defective and must be replaced.

6.2 BasicGuide / BasicGuide mini Receiver

Switch on device/connect headphones

The receiver is switched on by plugging in the earphones.

1. Insert the receiver plug into the receiver socket as far as it will go plug.
2. The LED on the top of the device lights up briefly and then goes out. If the charge level drops during operation, the LED lights up permanently. The devices then still have around 2 h remaining running time.
3. The device is ready for operation.

The receiver switches off when the earphones are removed. When not in use, the earphones should always be unplugged to protect the battery.

Adjust the volume and put on the earphones



CAUTION! Risk of hearing damage
High volume can cause hearing damage.

After switching on the receiver, set the volume to a low level before putting on the earpiece.

1. To avoid hearing damage, set the volume to a low level using the volume control knob (on the BasicGuide mini with the "Volume - / +" button).
2. MEDER uses ergonomic earphones that are suitable for both ears. Place the supplied earphones on the ear so that the cable is pointing backwards.
3. Check the volume on the earphones and adjust it using the volume control knob.

Set channel

The channel of the receiver is set using the channel remote setting via the transmitter (see page 18).

6.3 BasicGuide / BasicGuide mini Transmitter

Switching on the device/connecting the microphone

1. The transmitter is switched on and off using the "On/Off" button. If the microphone on the transmitter does not receive any sounds for 5 minutes, the transmitter switches off automatically.
2. The LED flashes 3 times. The color symbolizes whether the device is being used in rechargeable battery mode (red) or in battery mode (green).
3. The LED lights up continuously. On the transmitters, the LED indicates the charge status in 3 traffic light colors from green (full) to yellow and finally red (empty). When the LED lights up red, there are still about 15 minutes of remaining runtime available.

Connecting an external sound source to the transmitter

Alternatively, external audio material can also be recorded on the transmitter.

1. Remove any external microphone, windscreen pull off.
2. Connect the sound source to the microphone socket. The sound audio material is fed in via the socket. As soon as an external microphone or sound source is connected, the integrated microphone is automatically switched off.
3. Start playback on external device, pay attention to the volume.

Set channel

Use the "Channel -" button and the "Channel +" button to set the desired transmission channel. If several transmitters are in use at the same time, keep at least 1-2 channels between the channels in use if possible.

Remote channel setting

This function makes it possible to set a large number of receivers to one channel at the same time. To program the receivers, proceed as follows:

1. Switch on transmitter.
2. Set the desired channel on the transmitter. The current setting can be read off the display.
3. If present, remove the windscreen from the microphone head.
4. Insert the receivers into the charging slots or switch on the receivers switch on by plugging in an earphone.
5. Align the transmitter with the microphone in the direction of the upper part of the receiver. If the devices are inserted in the charging slots, this is not necessary.
6. Press the "IR" button to transmit the current settings of the transmitter, similar to a remote control. The range is approximately 1 m. The button can be held down. Several devices can be reached by swiveling the transmitter.
7. All receivers now have the channel setting of the transmitter. If this is not the case, check the alignment of the devices and repeat the process.

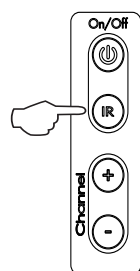

BasicGuide

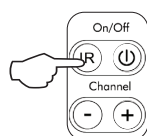
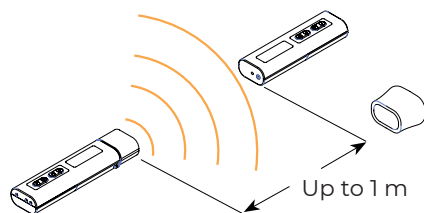

BasicGuide mini

The programming menu

The transmitter has a menu with two submenus in which the sensitivity (microphone sensitivity) (P1) and the so-called noise gate (P2) can be set. The corresponding symbol is shown on the display as a reminder.

Open programming menu:

1. Switch on the device.
2. Press the "On/Off" button and "Channel -" button simultaneously and hold for 1 second.
3. P1" appears on the display. You are now in the programming menu.
4. The "IR" button can be used to scroll through the submenus one after the other. to scroll through the submenus.

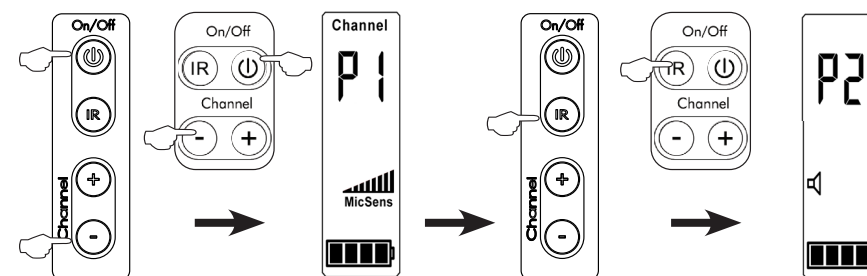

Submenu	Function	Operation
P 1	Sets sensitivity (microphone sensitivity). Symbol in the display: MicSens	Increase with "Channel +" button Decrease with "Channel -" button
P 2	Sets the noise gate. Icon: Loudspeaker 	Activate with "Channel +" button Deactivate with the "Channel -" button

Note:

The reminder icons are always shown on the display when switching between the submenus. are always shown on the display. However, this does not mean that the function is automatically activated.

If you want to activate the function, switch the function off once once and then turn it on again to confirm that the function has been activated.
 To deactivate, simply switch the symbol off.

You can exit the programming menu at any time. To do this as follows:

1. Press the "On/Off" button. This can be done in any of the submenus.
2. The device switches off and saves the changed values.
3. Switch the device back on. To do this, press the "On/Off" button.
4. The changes are now effective.



Setting the sensitivity (microphone sensitivity)

The correct microphone sensitivity setting ensures a good listening hearing sensation. A second person is recommended to check the reception. A receiver with earphones is essential for adjustment.

1. Switch on transmitter.
2. To open the programming menu, press the "On/Off" button and "Channel -" button simultaneously and hold for 1 second.
3. P1 appears on the display.
4. Switch on the receiver, put on the earphones.
5. Set the volume of the receiver to level 4.
6. Speak into the microphone. Do not adjust the receiver volume.
7. Use the "Channel -" button and the "Channel +" button on the transmitter to set the microphone sensitivity.
 The current value is shown on the  display.
 The sensitivity can be adjusted in 8 levels.
8. Adjust until the receiver has a pleasant hearing sensation. hearing sensation.
9. The sensitivity is now set correctly.
10. Exit the programming menu by pressing the "On/Off" button.
11. The transmitter switches off and saves the changed values.
12. The next time the device is switched on, the changed settings take effect.

Setting the noise gate

The noise gate can be used to prevent the transmission of unwanted background noise. This works as long as the wanted signal is louder than the interfering signal. This is almost always the case when speaking into the microphone. As soon as the signal at the microphone falls below a certain threshold, it is no longer transmitted at all. If the level rises above the limit again, the noise gate opens and the signal is sent again. This setting can be used to activate and deactivate the noise gate. When deactivated, the ambient noise is also sent. In most cases, the microphone should switch off when people are not speaking so that ambient noise is not transmitted. If the transmitter is to be used as a whisper microphone, this function must be deactivated.

1. Switch on the device.
2. To open the programming menu, press the "On/Off" button and "Channel -" button simultaneously and hold for 1 second.
3. P1 appears on the display.
4. Press the "IR" button once to select the P2 submenu.
 P2 appears on the display.
5. Deactivate the reminder (loupeker symbol). To do this, press the "Channel -" button. 
6. The loudspeaker symbol in the display goes  out.
7. If you want to deactivate the noise gate - skip the next steps and continue reading at 10. To activate the function continue at 8.
8. Activate the loudspeaker symbol again. To do this, press the "Channel +" button.
9. The loudspeaker symbol appears on the display.
10. Exit the programming menu by pressing the "On/Off" button.
11. The device switches off and saves the changed values.
12. The next time the appliance is switched on, the changed settings take effect.

7. Troubleshooting

Error	Reason	Solution
No function on the device, display shows nothing	Empty batteries or rechargeable batteries	Change batteries or recharge batteries (see p. 11)
	Fuse defective because batteries have been inserted the wrong way round	Send in device
No reception, Display shows settings	No signal, transmitter and receiver are on different channels	Reset channels, (see p. 16).
	No signal, transmitter out of range	Reduce distance
Reception too quiet/reception too loud	Incorrect sensitivity setting (microphone sensitivity).	Correct setting (see p. 19)
Operating time of the batteries greatly reduced	Natural ageing of the batteries	Replace batteries
Signal fails intermittent failure	Distance too large	Reduce distance
	Loose contact on the earphone	Try another earphone, replace defective one if necessary
	Unknown interference signal	Set the channel correctly (see p. 16 to p. 17)
Noise (hissing, crackling, whistling)	Distance between 2 transmitters too small	Increase distance (>10 m)
	Two transmitters broadcast on the same channel	The use of two transmitters at the same time is only possible with one adapter. Please call our Service Center.

Error	Reason	Solution
Cracking noises when operating the transmitter	Switch-on/switch-off noises or channel change noises from the transmitter are heard by the receiver.	Due to the transmission principle. Switch on the transmitter first, then switch on the receiver.
Another transmitter station is heard.	Receiver has the same channel as the unwanted transmitter.	Set the channel correctly (see p. 16 to p. 17)
	The channels used are adjacent channels (e.g. channels 2 and 3).	Increase the channel spacing (i.e. use channel 1, 3, 5 instead of channel 1, 2, 3) and/or increase the distance between transmitter and receiver (>10 m).
Transmitter transmits ambient noise	Noisegate deactivated	Correct setting (see p. 22)

Call the **MEDER** Service Center if you experience problems with your guidance system that are not listed in the table or if the problem cannot be solved with the suggested solutions listed in the table.

8. Manufacturer's declarations

Guarantee

We guarantee a 5-year factory warranty on all electronic components and accessories of our **TourGuide**-system.

If, despite our careful quality control, a defect should occur in the devices, they can be sent to our Service Center. The warranty services consist, at our discretion, of the free elimination of material or manufacturing defects by repair, replacement of parts or the complete device.



The following are excluded from the guarantee:

- Rechargeable batteries and batteries (these have a shorter service life, which also depends on the intensity of use in each individual case).
- Damage caused by leaking batteries (due to operating errors).
- Defects due to improper use (e.g. operating errors, mechanical damage, incorrect operating voltage)
- Defects due to natural wear and tear

Please use the return form available for download at www.meder-guiding.de. The warranty period starts from the date of purchase. As proof of purchase proof of purchase and send a copy with the products and the form in the event of a with the products and the form. The warranty claim expires if the product has been tampered with by unauthorized unauthorized persons or workshops.

Rechargeable batteries and batteries

The rechargeable batteries supplied are recyclable. Please dispose of them them via the battery container or a specialist retailer.

WEEE-Declaration

Your **MEDER** appliances are made from high-quality materials and components that can be recycled.

Electrical and electronic devices must be disposed of separately from household waste at the end of their useful life. Please dispose of this device at your local municipal collection point or recycling center. Please help to preserve our environment.



Declaration of conformity



BasicGuide

Hereby, **MEDER** CommTech GmbH declares that the radio equipment type **BasicGuide** is in compliance with Directive 2014/53/EU.

The full EU Declaration of Conformity is available at the following internet address: <https://www.meder-guiding.de/service/downloads/>



<https://www.meder-guiding.de/service/downloads/>

9. Technical data

BasicGuide

Dimensions	Transmitter: 165 x 42 x 25 mm Receiver: 136 x 42 x 25 mm
Weight incl. rechargeable batteries/batteries	Transmitter: 126 g Receiver: 111 g
Power consumption	Transmitter: ca. 80 mA Receiver: ca. 70 mA
Power supply	two 1.5V Mignon batteries (AA) or NIMH rechargeable batteries 2tk. LR6
Number of channels	8 channels pan-European approval 30 channels partial pan-European approval
Modulation	F3E
Frequencies	863 - 865 MHz (8 channels) 823 - 829 MHz (30 channels)
HF output power	< 10 mW
Sound transmission range	30 – 7500 Hz
Reach	150 m (open field)
Battery charging time	typ. 2-3 h
Operating time	Battery: typ. 35 h Rechargeable battery: typ. 30 h
Operating temperature	from -10 °C/14 °F to 60 °C/140 °F
Signal-to-noise ratio	> 70dB
Distortion factor at 1 kHz	< 1%
Headphone connection	Impedance 16 Ohm, max. 100 mW

BasicGuide mini

Dimensions	Transmitter: 135 x 42 x 25 mm Receiver: 105 x 42 x 25 mm
Weight incl. rechargeable batteries/batteries	Transmitter: 93 g Receiver: 70 g
Power consumption	Transmitter: ca. 80 mA Receiver: ca. 70 mA
Power supply	Lithium-Polymer-Akku (LiPo) 1300 mAh
Number of channels	8 channels pan-European approval 30 channels partial pan-European approval
Modulation	F3E
Frequencies	863 - 865 MHz (8 channels) 823 - 829 MHz (30 channels)
HF output power	< 10 mW
Sound transmission range	30 – 7500 Hz
Reach	150 m (open field)
Battery charging time	typ. 2-3 h
Operating time	Battery: typ. 30 h
Operating temperature	from -10 °C/14 °F to 60 °C/140 °F
Signal-to-noise ratio	> 70dB
Distortion factor at 1 kHz	< 1%
Headphone connection	Impedance 16 Ohm, max. 100 mW

Charging system

Dimensions	Cabinet: depending on version Station: depending on version Case: 85 x 53 x 23 cm
Weight	Cabinet: depending on version Station: depending on version Case: without appliances approx. 11 kg
Power supply	230 V, Schuko plug
Power consumption	Up to 800 W for charging cabinet with 200 charging bays Corresponds to approx. 3.6 W per charging bay
Charging bays	Cabinet: up to 210 Station: 30 to 120 (mobile and stationary) Case: 32
Operating conditions	from 10 °C/50 °F to 40 °C/104 °F
Storage conditions	from -10 °C/14 °F to 60 °C/140 °F
Charging current per slot	800 mA

10. Accessories

Description	Article no.
Single-ear headset with cable retractor	4010204080
One-ear headset	4010204030
Single-ear headphones with interchangeable headband	4010204055
Interchangeable headband for single-ear headphones	4010204056
Walkman handset	4010204045
Hygiene cover for Walkman handsets	4010204042
Storage case for 1 transmitter and 20 receivers	4010205010
Storage case for 3 transmitter and 30 receivers	4010205025
rechargeable Mignon	4010206010
battery Mignon	4010206020
induction loop	4010204051
Windshield Transmitter Passenger guide systems	4010201010
Windshield Headset	4010203040
Headset with mute switch	4010203026
Lanyard standard 42 cm with safety clasp	4010205055
Hygiene Spray for headset 500 ml	4010204090

Get free advice on our accessories for the BasicGuide.

Call our Service Center or find out more on our homepage:

www.meder-guiding.de

Non-contractual illustrations.

Subject to change without notice.

Imprint

MEDER CommTech GmbH

Robert-Bosch-Str. 4

78224 Singen, Germany

Tel: +49 (0)7731 911 322 0

Fax: +49 (0)7731 911 322 99

info@meder-commtech.com

www.meder-guiding.de

This document is available free of charge at
www.meder-guiding.de.

Status: May 2025



MEDER CommTech GmbH

Robert-Bosch-Straße 4

78224 Singen

Germany

Tel.: +49 (0) 7731 911 322 0

Fax: +49 (0) 7731 911 322 99

info@meder-commtech.com

www.meder-guiding.de